

Ceiling Concealed High Pressure FCU

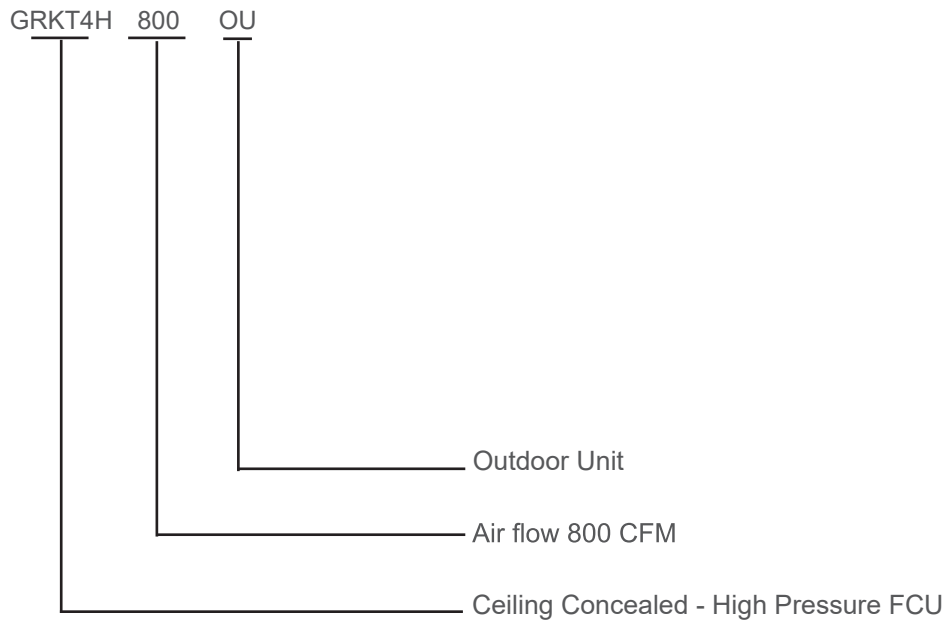

Characteristics:

- Large air flow, range from 655CMH to 6200CMH
- High external static pressure, up to 180Pa.



GRKT4H Ceiling Concealed High Pressure FCU

| Model GRKT4H | | 800OU | | | 1000OU | | | 1200OU | | | 1600OU | | | |
|--|---------------------------------|---|--------|-------|---------|--------|-------|---------|--------|-------|---------|--------|-------|-------|
| | | High | Medium | Low | High | Medium | Low | High | Medium | Low | High | Medium | Low | |
| Air Flow m ³ /h | Standard (S) | 0 Pa | 1400 | 1090 | 880 | 1610 | 1285 | 1035 | 2050 | 1640 | 1305 | 2640 | 2105 | 1685 |
| | | 40 Pa | 1200 | 960 | 775 | 1420 | 1135 | 915 | 1850 | 1450 | 1155 | 2355 | 1885 | 1510 |
| | | 80 Pa | 1030 | 820 | 655 | 1230 | 985 | 790 | 1560 | 1250 | 1000 | 2095 | 1675 | 1340 |
| | High static pressure (H) | 80 Pa | 1460 | 1170 | 945 | 1715 | 1380 | 1100 | 2195 | 1745 | 1400 | 2820 | 2255 | 1805 |
| | | 130 Pa | 1265 | 1015 | 815 | 1510 | 1215 | 970 | 1925 | 1540 | 1230 | 2490 | 1990 | 1595 |
| | | 180 Pa | 1075 | 860 | 690 | 1305 | 1045 | 835 | 1660 | 1330 | 1065 | 2160 | 1730 | 1385 |
| Total Cooling Capacity kW | Standard (S) | 0 Pa | 8.78 | 7.02 | 5.63 | 10.52 | 8.41 | 6.74 | 13.39 | 10.72 | 8.57 | 17.22 | 13.78 | 11.02 |
| | | 40 Pa | 7.85 | 6.28 | 5.03 | 9.27 | 7.42 | 5.94 | 11.80 | 9.45 | 7.94 | 15.17 | 12.14 | 9.71 |
| | | 80 Pa | 6.99 | 5.59 | 4.47 | 7.98 | 6.39 | 5.11 | 10.16 | 8.13 | 6.49 | 13.05 | 10.44 | 8.36 |
| | High static pressure (H) | 80 Pa | 9.38 | 7.50 | 6.01 | 11.26 | 9.00 | 7.21 | 14.31 | 11.45 | 9.15 | 18.40 | 14.72 | 11.78 |
| | | 130 Pa | 8.29 | 6.64 | 5.30 | 9.87 | 7.90 | 6.31 | 12.04 | 9.63 | 7.70 | 15.93 | 12.75 | 10.20 |
| | | 180 Pa | 7.19 | 5.75 | 4.60 | 8.49 | 6.79 | 5.43 | 9.84 | 7.86 | 6.29 | 13.50 | 10.80 | 8.63 |
| Sensible Cooling Capacity kW | Standard (S) | 0 Pa | 6.47 | 5.18 | 4.14 | 7.88 | 6.30 | 5.04 | 9.72 | 7.78 | 6.23 | 12.83 | 10.27 | 8.22 |
| | | 40 Pa | 5.79 | 4.63 | 3.71 | 6.95 | 5.55 | 4.43 | 8.57 | 6.86 | 5.48 | 11.30 | 9.05 | 7.23 |
| | | 80 Pa | 5.16 | 4.12 | 3.30 | 5.98 | 4.78 | 3.82 | 7.37 | 5.96 | 4.71 | 9.73 | 7.78 | 6.23 |
| | High static pressure (H) | 80 Pa | 6.92 | 5.53 | 4.44 | 8.42 | 6.74 | 5.39 | 10.39 | 8.32 | 6.65 | 13.71 | 10.97 | 8.78 |
| | | 130 Pa | 6.11 | 4.89 | 3.92 | 7.39 | 5.91 | 4.73 | 8.75 | 6.99 | 5.60 | 11.87 | 9.51 | 7.61 |
| | | 180 Pa | 5.05 | 4.25 | 3.39 | 6.36 | 5.08 | 4.07 | 7.14 | 5.71 | 4.57 | 10.06 | 8.05 | 6.44 |
| Heating Capacity kW | Standard (S) | 0 Pa | 13.35 | 10.68 | 8.54 | 16.17 | 12.93 | 10.34 | 20.86 | 16.69 | 13.36 | 26.00 | 20.80 | 16.64 |
| | | 40 Pa | 11.75 | 9.40 | 7.52 | 14.29 | 11.43 | 9.14 | 18.41 | 14.73 | 11.78 | 23.25 | 18.61 | 14.88 |
| | | 80 Pa | 10.07 | 8.06 | 6.45 | 12.38 | 9.90 | 7.92 | 15.89 | 12.72 | 10.17 | 20.67 | 16.54 | 13.24 |
| | High static pressure (H) | 80 Pa | 14.26 | 11.42 | 9.12 | 17.28 | 13.83 | 11.06 | 22.29 | 17.84 | 14.27 | 27.79 | 22.24 | 17.79 |
| | | 130 Pa | 12.37 | 9.89 | 7.91 | 15.19 | 12.51 | 9.72 | 19.60 | 15.68 | 12.54 | 24.56 | 19.65 | 15.73 |
| | | 180 Pa | 10.49 | 8.39 | 6.71 | 13.09 | 10.47 | 8.38 | 16.89 | 13.52 | 10.81 | 21.31 | 17.05 | 13.64 |
| Motor | Power Supply | 220V~50Hz | | | | | | | | | | | | |
| | Type | Split-capacitor motor with ball bearing | | | | | | | | | | | | |
| | Insulation Class | B | | | | | | | | | | | | |
| | Quantity(S/H) | 1/1 | | | 1/1 | | | 1/1 | | | 1/1 | | | |
| Fan Quantity | | 1 | | | 1 | | | 1 | | | 1 | | | |
| High Rated Power Input W (S/H) | | 200/280 | | | 280/370 | | | 300/600 | | | 350/700 | | | |
| Water Flow Rate m ³ /h | | 1.60 | | | 1.88 | | | 2.39 | | | 3.08 | | | |
| Water Pressure Drop kPa | | 6 | | | 14 | | | 25 | | | 20 | | | |
| Dimension (Without return air plenum) | Length mm | 860 | | | 860 | | | 960 | | | 1110 | | | |
| | Width mm | 770 | | | 770 | | | 770 | | | 770 | | | |
| | Height mm | 430 | | | 430 | | | 430 | | | 430 | | | |
| Net Weight | (Without return air plenum) kg | 40 | | | 40 | | | 46 | | | 53 | | | |
| | (With return air plenum) kg | 50 | | | 50 | | | 56 | | | 65 | | | |
| Pipe connection | | R 1 (Taper Pipe Male Threaded) | | | | | | | | | | | | |
| Condensate Drain Size | | R 1(Taper Pipe Male Threaded) | | | | | | | | | | | | |

- Cooling capacity is based on the following:
 - Water temperature: 7 C(inlet)/12 C(outlet)
 - Air entering condition:27 C DB/19.5 C WB
- Heating capacity is based on the following(with same water flow rate as cooling cycle):
 - Water temperature: 60 C (inlet)
 - Air entering condition:21 C DB
- The air volume is tested under entering air condition of 20 C DB and dry coil condition.
- High Static Pressure Series Units may drift water when excess pressure of air duct is less than 80Pa.
- The standard type (S) without return air plenum (Optional).High static pressure (H) with back return air plenum.
- The nameplate of standard type (S) is 40Pa,and high static pressure (H) is 130Pa.
- Please contact factory if need thermostat and three-way switch.
- The manufacturer reserves the rights to make changes to the above specifications without prior notice.

GRKT4H Ceiling Concealed High Pressure FCU

| Model GRKT4H | | | 1800OU | | | 2000OU | | | 3000OU | | |
|---------------------------------------|---------------------------------|--------|---|--------|-------|-----------------------------------|--------|-------|----------|--------|-------|
| | | | High | Medium | Low | High | Medium | Low | High | Medium | Low |
| Air Flow m ³ /h | Standard (S) | 0 Pa | 3120 | 2495 | 2000 | 4000 | 3195 | 2550 | 5850 | 4680 | 3735 |
| | | 40 Pa | 2800 | 2240 | 1795 | 3860 | 3100 | 2475 | 5155 | 4140 | 3300 |
| | | 80 Pa | 2510 | 2010 | 1610 | 3610 | 2890 | 2320 | 4455 | 3565 | 2860 |
| | High static pressure (H) | 80 Pa | 3335 | 2670 | 2135 | 4200 | 3345 | 2685 | 6200 | 4990 | 4000 |
| | | 130 Pa | 2945 | 2360 | 1890 | 3880 | 3100 | 2485 | 5500 | 4395 | 3520 |
| | | 180 Pa | 2555 | 2050 | 1640 | 3555 | 2850 | 2285 | 4735 | 3800 | 3040 |
| Total Cooling Capacity kW | Standard (S) | 0 Pa | 20.41 | 16.32 | 13.07 | 26.10 | 20.89 | 16.73 | 38.25 | 30.61 | 24.49 |
| | | 40 Pa | 17.97 | 14.38 | 11.50 | 25.25 | 20.21 | 16.16 | 33.71 | 26.99 | 21.55 |
| | | 80 Pa | 15.43 | 12.34 | 9.87 | 23.52 | 18.82 | 15.05 | 29.02 | 23.22 | 18.55 |
| | High static pressure (H) | 80 Pa | 21.81 | 17.45 | 13.96 | 27.42 | 21.92 | 17.55 | 40.90 | 32.70 | 26.15 |
| | | 130 Pa | 19.11 | 15.29 | 12.22 | 24.26 | 19.39 | 15.53 | 34.41 | 27.51 | 22.01 |
| | | 180 Pa | 16.42 | 13.13 | 10.50 | 21.10 | 16.86 | 13.51 | 28.11 | 22.46 | 17.98 |
| Sensible Cooling Capacity kW | Standard (S) | 0 Pa | 15.25 | 12.20 | 9.76 | 18.96 | 15.17 | 12.16 | 27.77 | 22.23 | 17.80 |
| | | 40 Pa | 13.43 | 10.74 | 8.59 | 18.35 | 14.68 | 11.74 | 24.50 | 19.60 | 15.66 |
| | | 80 Pa | 11.53 | 9.22 | 7.37 | 17.07 | 13.65 | 10.92 | 21.06 | 16.84 | 13.46 |
| | High static pressure (H) | 80 Pa | 16.31 | 13.03 | 10.43 | 19.91 | 15.93 | 12.75 | 29.69 | 23.77 | 19.00 |
| | | 130 Pa | 14.28 | 11.42 | 9.14 | 17.62 | 14.09 | 11.29 | 25.00 | 19.98 | 15.99 |
| | | 180 Pa | 12.27 | 9.81 | 7.85 | 15.32 | 12.24 | 9.82 | 20.41 | 16.31 | 13.07 |
| Heating Capacity kW | Standard (S) | 0 Pa | 30.34 | 24.28 | 19.42 | 40.67 | 32.55 | 26.07 | 59.58 | 47.69 | 38.16 |
| | | 40 Pa | 27.24 | 21.80 | 17.43 | 39.39 | 31.52 | 25.24 | 52.60 | 42.09 | 33.66 |
| | | 80 Pa | 24.42 | 19.54 | 15.62 | 36.79 | 29.45 | 23.58 | 45.39 | 36.34 | 29.06 |
| | High static pressure (H) | 80 Pa | 32.44 | 25.96 | 20.76 | 42.70 | 34.17 | 27.37 | 63.70 | 50.96 | 40.78 |
| | | 130 Pa | 28.66 | 22.93 | 18.34 | 39.47 | 31.58 | 25.29 | 55.99 | 44.79 | 35.84 |
| | | 180 Pa | 24.86 | 19.89 | 15.91 | 36.22 | 28.99 | 23.22 | 48.24 | 39.62 | 30.89 |
| Motor | Power Supply | | 220V~50Hz | | | | | | | | |
| | Type | | Split-capacitor motor with ball bearing | | | | | | | | |
| | Insulation Class | | B | | | | | | | | |
| | Quantity(S/H) | | 1/2 | | | 2/2 | | | 3/3 | | |
| Fan Quantity | | | 2 | | | 2 | | | 3 | | |
| High Rated Power Input W (S/H) | | | 600/750 | | | 650/1200 | | | 900/1800 | | |
| Water Flow Rate m ³ /h | | | 3.65 | | | 4.50 | | | 6.16 | | |
| Water Pressure Drop kPa | | | 25 | | | 35 | | | 45 | | |
| Dimension (Without return air plenum) | Length mm | | 1260 | | | 1560 | | | 2010 | | |
| | Width mm | | 770 | | | 770 | | | 770 | | |
| | Height mm | | 430 | | | 430 | | | 430 | | |
| Net Weight | (Without return air plenum) kg | | 64 | | | 80 | | | 108 | | |
| | (With return air plenum)kg | | 76 | | | 94 | | | 126 | | |
| Pipe connection | | | R 1 (Taper Pipe Male Threaded) | | | R 1 1/2(Taper Pipe Male Threaded) | | | | | |
| Condensate Drain Size | | | R 1 (Taper Pipe Male Threaded) | | | | | | | | |

Note:

- Cooling capacity is based on the following:
 - Water temperature: 7 C(inlet)/12 C(outlet)
 - Air entering condition:27 C DB/19.5 C WB
- Heating capacity is based on the following(with same water flow rate as cooling cycle):
 - Water temperature: 60 C (inlet)
 - Air entering condition:21 C DB
- The air volume is tested under entering air condition of 20 C DB and dry coil condition.
- High Static Pressure Series Units may drift water when excess pressure of air duct is less than 80Pa.
- The standard type (S) without return air plenum (Optional).High static pressure (H) with back return air plenum.
- The nameplate of standard type (S) is 40Pa,and high static pressure (H) is 130Pa.
- Please contact factory if need thermostat and three-way switch.
- The manufacturer reserves the rights to make changes to the above specifications without prior notice.

Dimension

Celling Concealed - High Pressure FCU

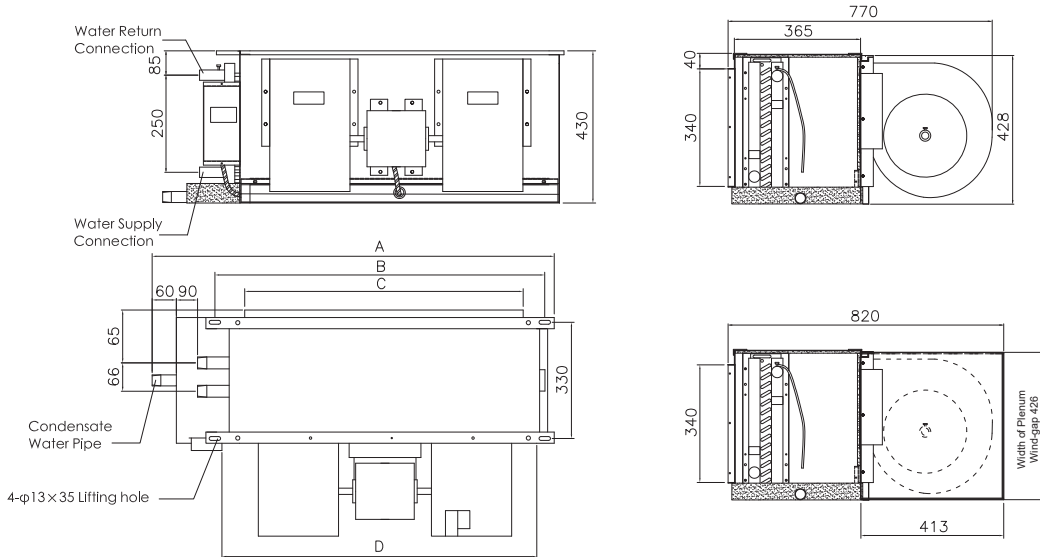

| Model | 800/1000 | 1200 | 1600 | 1800 | 2000 | 3000 |
|---------------------------|----------|------|------|------|------|------|
| Length of Plenum Wind-gap | 653 | 653 | 753 | 923 | 1373 | 1823 |

| Model GRKT4H | A | B | C | D | Inlet/outlet Pipe | Condensate Water Pipe | Motor Quantity (S/H) | Fan Quantity |
|--------------|------|------|------|------|-------------------|-----------------------|----------------------|--------------|
| 800OU | 860 | 683 | 530 | 590 | R1 | R1 | 1/1 | 1 |
| 1000OU | 860 | 683 | 530 | 590 | R1 | R1 | 1/1 | 1 |
| 1200OU | 960 | 783 | 630 | 690 | R1 | R1 | 1/1 | 1 |
| 1600OU | 1110 | 953 | 800 | 860 | R1 | R1 | 1/1 | 2 |
| 1800OU | 1260 | 1083 | 930 | 990 | R1 | R1 | 1/2 | 2 |
| 2000OU | 1560 | 1403 | 1250 | 1310 | R1 ^{1/2} | R1 | 2/2 | 2 |
| 3000OU | 2010 | 1853 | 1700 | 1760 | R1 ^{1/2} | R1 | 3/3 | 3 |